

SHERWOOD 2030BC MULTIVALVE WITH DOUBLE CHECK FILLER VALVE

Sherwood multivalve permits filling of DOT cylinders up to 200 lbs. propane capacity from bulk truck. Features teflon coated stem for added operating life and a positive back seat. Double check filler valve provides extra protection against leakage. Safer, faster filling due to spray fill cooling effect. 3/4" NGT inlet has Everseal coating for direct installation into cylinder without additional sealant.



RMI Part No.*	Inlet	Filler Valve	Cylinder Capacity	Outlet
2030BC11.6E	3/4" NGT w/Everseal	1 3/4" ACME	100#	POL
2030BC10.6E	3/4" NGT	1 3/4" ACME	200#	POL
2030BC8.6E	3/4" NGT	1 3/4" ACME	60#	POL

*Bulk packages of 500 valves are available for additional savings: add -B suffix to part no.



2030BC Series



Sherwood

SHERWOOD MULTIVALVES

Sherwood has now standardized on new 1/8" tapping after shut-off on all multi-valves and service valves for 100 gallon through 1990 gallon tanks. This allows direct access for "gas-check" leak testing of piping system without breaking connections in gas tight line.

SHERWOOD 2035AP 1" MULTIVALVE

Sherwood multivalve for use on DOT or ASME containers 420 & 300 lbs. or 125 gallons capacity. 1" NGT inlet thread has Everseal coating for direct installation into cylinder without additional sealant.

Caution: Order 375 PSI relief for DOT containers, 250 PSI relief for ASME containers.



2035A Series

RMI Part No.	Relief Setting	Cylinder Type	Inlet	Outlet	Description
2035AT11.7E	375	420# DOT	1" NGT	POL	1/8" Tap Plugged
2035AT10.3E	375	300# DOT	1" NGT	POL	1/8" Tap Plugged
2035AT25011.6E	250	100 Gal. ASME	1" NGT	POL	1/8" Tap Plugged

SHERWOOD 2033 3/4" ASME MULTIVALVE



SHERWOOD 2033CLT 3/4" STANDARD MULTIVALVE

Sherwood multivalve for use on ASME tanks. Standard 15" dip tube may easily be cut to required length by customer. Now with either 1/8" tap.

RMI Part No.	Outlet	Vapor Return	Description
2033CLT15.0	POL	1 1/4" ACME	1/8" Tap Plugged

SHERWOOD 2033CLDBT DUAL BONNET MULTIVALVE



Gas Check Ready Valve

Sherwood Dual Bonnet multi-purpose valve features a one piece bonnet and stem assembly for easy repair while valve is open - so gas service is not interrupted. Now with 1/8" tap.

RMI Part No.	Outlet	Vapor Return	Description
2033CLDBT15.0	POL	1 1/4" ACME	1/8" Tap Plugged

© Ray Murray Inc. Edition 11

CYLINDER VALVES



SHERWOOD STANDARD CYLINDER VALVE

Sherwood valve for 100 lb. capacity cylinders, complete with integral relief, rugged forged brass body, swivel nylon seat and 10% liquid level vent valve. New teflon coated stem assures long operating life and provides positive back seat. ³/₄" NGT inlet.

3250CLG

RMI Part No.	OUTLET	Features	Relief Settings
3250CLG-11.6	POL	Standard Valve w/11.6" D.T.	375
3250CLG-10.6	POL	Standard Valve w/10.6" D.T.	375
3250CLG-8.6	POL	Standard Valve w/8.6" D.T.	375



SHERWOOD LIQUID WITHDRAWAL VALVE

Sherwood valve for 100 lb. capacity cylinder. Used for torch & liquid tar kettle applications. Excess flow check provides added safety. Dip pipe "T" dimension of 44" standard. Dip tube of 11.6 enables filling by volume. ³/₄" inlet thread.

3250ALM11.6

RMI Part No.	Outlet
3250ALM11.6	982 MALE, CGA 555

SHERWOOD PROPANE/PROPYLENE CYLINDER VALVE

Our new 3250R series valve is a multi-purpose cylinder valve with a unitized pressure relief valve and a start to discharge pressure for both 4BW240 and 4BW260 cylinders for propane and propylene service.

- Replaceable CG-7 Pressure Relief Device (PRD) set to 435-480 PSI
- Conforms to UL Standard 1769
- Compliant with CGA Technical Bulletin TB27-2007 for propylene cylinders
- Tamper resistant pinned bonnet
- For use in up to 100 lb LPG capacity cylinders



RMI Part No.	OUTLET	Features	Relief Settings
3250CLG435-10.7	POL	Standard Valve w/10.7" DT	435
3250CLG435-10.2	POL	Standard Valve w/10.2" DT	435
3250CLG435-10.0	POL	Standard Valve w/10.0" DT	435

SHERWOOD 3250C CYLINDER VALVE



Sherwood

Valves do not include standard 10% dip tubes. Available with 375 PSI.



3250C

RMI Part No.	Description	Relief Settings
3250C375	3/4" Valve - No Dip Tube	375
3250C435	3/4" Valve - No Dip Tube	435

SHERWOOD 3250BC ASME TANK VALVE



Sherwood

Sherwood Valve for small ASME motor fuel tanks of 20 sq. ft. or less surface area. 312 PSIG relief setting.



3250BC312

RMI Part No.	OUTLET	Features
3250BC312	POL	312 PSIG ASME Valve



3250AD7



Sherwood

SHERWOOD VALVE WITHOUT RELIEF

This valve is used where a separate safety relief is provided on container, inlet $\frac{3}{4}$ " NGT. Now available with $\frac{1}{8}$ " tapping for easy "Gas Check" leak testing.

RMI Part No.	Outlet	Description	Features	Relief Settings
3250AD7	POL	Standard	--	NO
3250ALG7T11.0	POL	10% Valve, 11" Dip Tube	1/8" Plug	NO
3329BDBT	POL	Underground Multivalve	1/8" Plug	NO

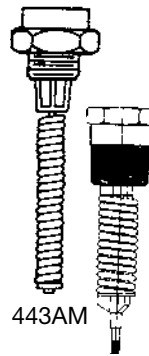

443AM

445AM



Sherwood

BULK TANK RELIEF VALVES

Sherwood internal relief valve for ASME bulk tanks 120-1000 WG. and new style DOT 420 lb. cylinder with separate relief valve.

RMI Part No.	Container Connection	Relief Setting	Rain Cap	Tank Capacity
445AM	1"	250	P206	ASME 100 Gal. Vert.
445AT	1"	375	P206	DOT 420 lb.
433AM	$\frac{3}{4}$ "	250	433-45	ASME 120-320 WG
443AM	1"	250	443-45	ASME 500 WG
453AM	$1\frac{1}{4}$ "	250	453-45	ASME 1000 WG

CYLINDER VALVES



Sherwood

SHERWOOD AFV10 FILLER VALVE

Double back check filler valves for ASME tanks. Sizes 120 through 1000 gallon. Filling rates are approximately 105 GPM.

RM Part No.	ACME Thread	Tank Conn.
AFV10	1 $\frac{3}{4}$ " ACME	1 $\frac{1}{4}$ " NPT

UNDERGROUND TANK CLUSTER VALVE REMOVAL TOOL



- Durable cast steel construction
- Powder coat finish for maximum corrosion protection
- 3/4" drive



RMI Part No.	Description
MEP126	Underground Tank Cluster Valve Removal Tool

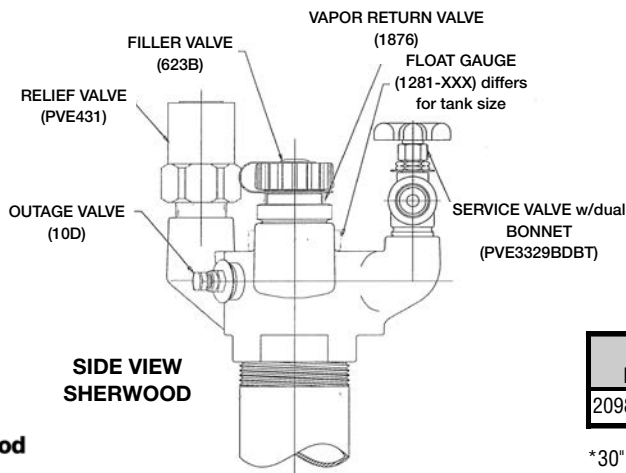

UNDERGROUND VALVE

Sherwood valves have ductile iron body, Cavagna valves have brass body. Both contain standard valves for the individual components of service valve, filler valve, relief valve, vapor return and 10% outage valve. Suitable for underground tanks up to 300 sq. ft of surface area (1000 underground tank).

RMI Part No.	Brand	Inlet	Outlet	Surface Area of Underground Container
2098AT30.0*	Sherwood	POL	2 $\frac{1}{2}$ " FNPT	300 sq. ft.

*30" Standard DIP tube, must be cut to DIP tube length specified on tank.



Sherwood

**2341
TRANSFER VALVES**

For use in liquid withdrawal from bulk system tanks. High rise seat and large port make for low pressure drop and maximum flow when PA5133 adaptor is used on valve inlet. Excellent for activating check lock type liquid fitting on tanks. 3/4" NPT inlet.



2341 Series

RMI Part No.	Outlet
2341	3/4" NPT
2341A	1/2" NPT
2341C	1 3/4" ACME Male
2341X*	3/4" NPT

* Includes excess flow check 19.5 GPM. Alternate combination: No. 2341 & F101.

**A1596R
TRANSFER VALVE**

Liquid transfer valve with built-in hydrostatic relief. Does not relieve gas to atmosphere. When down stream pressure exceeds tank pressure by 50 PSI, relief valve opens and bleeds it back into tank. New excess flow valve assures positive checking at rated flow.



A1596R,
A1597R

RMI Part No.	Inlet	Outlet	Excess Flow
A1596R	1 1/4"	1"	35 GPM
A1597R	1 1/4"	1"	55 GPM

CYLINDER VALVES



PA5133



PA5133M



Sherwood

**CHECKMATE
ADAPTORS**

Check Mate Adaptor with Nylon Gasket

RMI Part No.	Special Inlet	Outlet
PA5133	3/4" MNPT	3/4" FNPT
PA5133M	3/4" MNPT	3/4" MNPT
5133-10	Replacement Gasket Only	



Sherwood

VAPOR RETURN VALVE

Vapor return and excess-flow valve for vapor return outlet allowing fast filling of ASME supply tanks.



1876

RMI Part No.	Tank Connection	ACME Thread
1876	3/4" NPT	1 1/4" ACME

CHECKMATE ADAPTOR & VALVES



Sherwood

- Improved gas tight seal during connect and disconnect operations
- Accommodates permanent installation
- Rated for high on liquid



5136 or 5137



5138

RMI Part No.	Description	Inlet	Outlet	Tank Connection
5138	CheckMate Adaptor	1" F NPS	3/4" FNPT	--
5136	CheckMate Valve	--	1" M NPS	3/4"
5137	CheckMate Valve	--	1" M NPS	1 1/4"
458-3	Teflon Gasket for Cap			
458-4	O-Ring for PA5138			

OPD TYPE 1 VALVE WITH OVERFILL PROTECTION DEVICE



80-8107

- Double O-ring stem seal provides extra safety and protection from stem leaks.
- Rugged handwheel easily identifies OPD valve.
- All valves come with sealant on tank threads for direct installation into cylinder.
- TYPE 1 connections offer flow restriction and thermal protection when attached to coupling.
- Positive back check prevents accidental release of gas when coupling is not attached.

RMI Part No.	Tank Connection	Dip Tube Length	Standard Cylinder Size	Cylinder I.D.	Cylinder Water Capacity
80-8107	3/4"-14 NPT w/Everseal	4.0"	20# Steel	12"	47.6
80-8109		4.8"	30# Steel	12"	71.4
80-8110		6.5"	40# Steel	12"	95.2

Note: Valves with other dip tube lengths will be added as the valves become available.

OPD REPLACEMENT VALVES

RMI Part No.	OPD Size (LBS)	Material	Recommended Cylinder (Inches)	Cylinder Water Cap. (LBS)	Dip Tube Length (Inches)
294012	4.25	Steel	8.9	10.2	2.2
V21113	5	Steel	7.8	11.9	3
N/A	6	Steel	7.5	15.5	3.2
V21130	10	Steel	8.9	26.1	3.6
V21113	11	Steel	8.9	26.2	3
N/A	11.5	Steel	12	27.3	3.2
80-8107	20	Steel	12	47.6	4
N/A	25	Steel	12	59.7	4.8
80-8109	30	Steel	12	71.5	4.7
80-8110	40	Steel	12	95.3	6.4
299480	6	Aluminum	6	15	4.8
V21130	10	Aluminum	10	23.6	3.6
V20691	20	Aluminum	12	47.6	4.7
295178	30	Aluminum	12	71.5	6
295179	40	Aluminum	12	95.2	7

SHERWOOD: CYLINDER, MULTI & PLUMBER'S POT VALVES

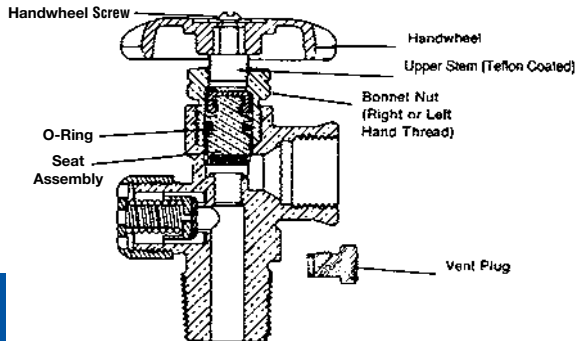

SHERWOOD VALVE MODELS

Description	Valve Model				
	3329, 1427C 2030C, CP 2033, 1445C	2035A 2035AP 3250A, ALM	1427B 1425B, 1426B 1445B, 1446B	1447D 1446D	3359AS 3359ASW
	RMI Part No.				
Handwheel Screw	3740-13	3740-13	3740-13	3740-13	3740-13
Handwheel	3329-7	1901	1901S	1901S	1901S
Dip Tube-Specify Length	1929-23	1929U-23	--	--	--
L.H. Bonnet, Stem, O-Ring & Seat Ass'y	3329-13LH	3250-8LH	3250-8LH	3250D-8LH	3250-8ALH
Vent Plug	1931-24A	1931-24A	--	--	--

REPLACEMENT KITS/PARTS FOR SHERWOOD VALVES

Valve Type	RMI Part No.	Description	Valve Model
Quick Acting Valves	440-50	Bonnet Assy. Kit	440 Series
Dual Bonnet	6775-60	Replacement Bonnet	2033CLDB15.0 Only
Dual Bonnet	3429-100	Conversion Kit	2033CLDB15.0
Transfer Valve	2341-100	Replacement Kit	2341 Series
Multivalve 2030BC	2030-100	Filler Section Replacement Kit	2030BC
	U701-19	Protective Cap	2030BC Relief Valve
	1850-3	1 3/4" ACME Cap	2030BC Filler
ASME Tank Valve	2033-100-KIT	Repair Kit	2033 Series
	1875-3A	1 1/4" ACME Cap	2033 Filler
Multivalve 2035	2035-100	Filler Section Replacement Kit	2035 Series
	UT12X	Protective Cap	2035 Relief Valve
	1850-3	1 3/4" ACME Cap	2035 Filler
Filler Valve 1855	1855-100	Repair Kit	1855 Series
	1850-3	1 3/4" ACME Cap	1855 Filler
Filler Valve 623	623B-100	Repair Kit	623 Series
	1850-3	1 3/4" ACME Cap	623 Filler

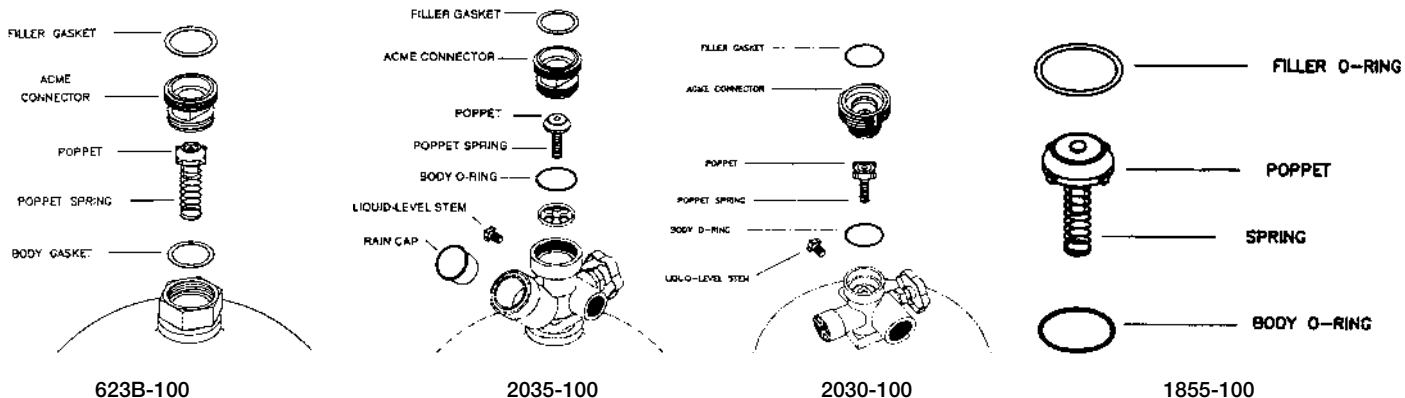
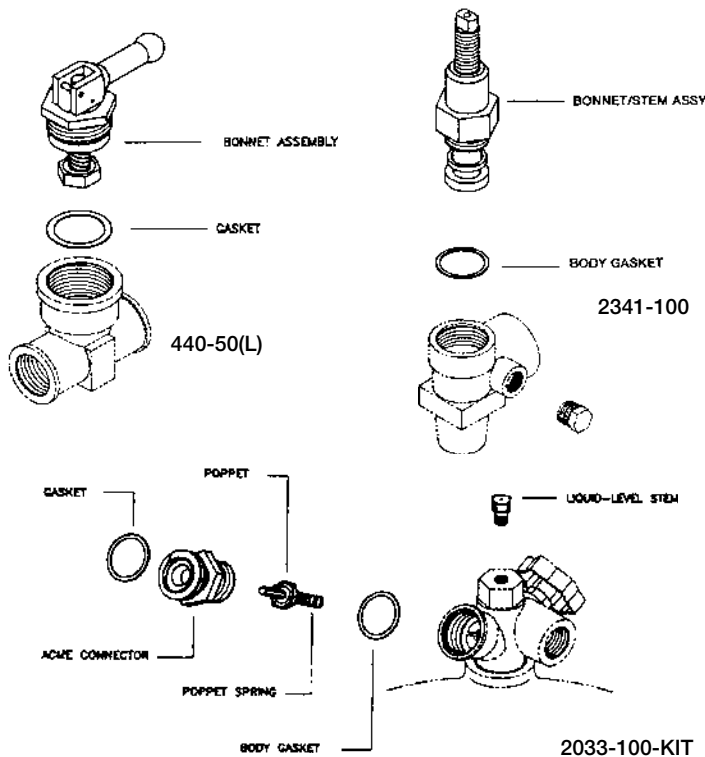



SHERWOOD DOT VALVE



1427B

Sherwood service valve is designed for DOT lift truck cylinders. New internal excess flow provides consistent flow check on all cylinders and low temperatures. 1449 is low profile version of 1427B.

Liquid or vapor service.

RMI Part No.	Tank Connection	Outlet	Excess Flow Valve
1427B	3/4"	3/8" MNPT	1.7 GPM
1449	3/4"	3/8" MNPT	1.7 GPM

SHERWOOD LIFT TRUCK CONNECTORS



1428F



1428M

Sherwood 1 1/4" ACME lift truck safety check connectors are interchangeable with all 1 1/4" ACME lift truck adaptors. (Max working pressure 250 PSI)

RMI Part No.	Inlet	Outlet
1428F	1 1/4" F ACME	1/4" FNPT
1428M	3/8" FNPT	1 1/4" M ACME
W-4	Outer Gasket for 1428M	
O-114	Inner O-ring for 1428M	

ROCHESTER FLOAT GAUGES FOR LIFT TRUCK CYLINDERS

Universal Float Gauges
(Horizontal & Vertical Mount)

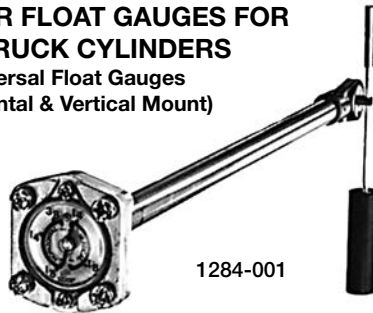

1284-001

ROCHESTER FLOAT GAUGES/LIFT TRUCK CYLINDERS

RMI Part No.				
Junior 4-Bolt Flanged	1 1/4" Screw Threaded Type	3/4" Screw Threaded Type	Replacement Dial	Cylinder Size (lb.)
6284-33	7284-33	7384-15	5-01815	20
1284-001*	2284-001*	7384-16	5-01791	33 1/2
6284-35	7284-35	7384-17	5-01824	43 1/2
HORIZONTAL ONLY FLOAT GAUGES				
6284-24	7284-24	7384-18	5-01789	20, 33 1/2, 43 1/2

* Brass mounting head

SHERWOOD DOT RELIEF VALVES



435A



435L



435-45

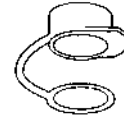

435-45C



Sherwood relief valves with 375 PSI setting for DOT lift truck cylinders. New 435L is designed with shorter projection for use in older cylinders where 435A bottoms out against cylinder coupling. 435L may also be used with new cylinders.

RMI Part No.	Description
435A	3/4" NPT Relief Valve-375 PSI
435L	3/4" NPT for Old Style Cylinders
435-45	45° Pipe Away Adaptor
435-90	90° Pipe Away Adaptor
435-45C	Rain Cap

FILLER VALVES



Sherwood AFV6

1 3/4" ACME filler valves for DOT and ASME cylinders and tanks.

- Low-profile design for bulk tank and engine fuel applications
- Optimized fill spray pattern and high filling capacity
- Improved piston alignment and seal
- Durable, mechanically assembled poppet and seal design
- Low differential shutoff



Sherwood

RMI Part No.	Tank Connection	Outlet
AFV6	3/4"	1 3/4" ACME
AFV6-30	3/4"	30° ACME
1850-10	Replacement Cap & Chain	
W-2	1 3/4" ACME WASHER	
O-216	1 3/4" O-RING	

DIAGRAM OF TYPICAL FORKLIFT CYLINDER

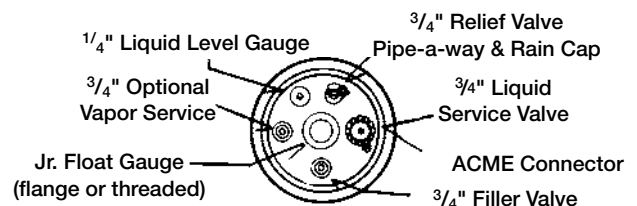



1447B ASME VALVE



Sherwood Service Valve is designed for ASME motor fuel tanks. Internal excess flow provides consistent flow check at 1.7 GPM (tests for 550 cubic inches engines on full load is 1.08 GPM)

1447B



1447C
(Low Profile)

RMI Part No.	Tank Conn.	Outlet	Excess Flow	Built-in Relief
1447B	3/4"	3/8" Flare	1.7 GPM	Yes
LOW PROFILE				
1447C	3/4"	3/8" Flare	1.7 GPM	Yes



1447D VALVE



Sherwood Motor Fuel Valve has internal back to tank hydrostatic relief valve allowing trapped line pressure back to tank instead of to atmosphere.

1447D

RMI Part No.	Tank Conn.	Outlet	Excess Flow	Built-in Relief
1447D	3/4"	3/8" Flare	1.7 GPM	Yes

REMOTE FILLER VALVES



1855SPD



1855SD-90

Sherwood double check filler valves with rubber seats for use in remote filling on ASME motor fuel tanks. Filling rate 20 GPM.

RMI Part No.	Tank Conn.	Outlet
1855SPD	3/4" MNPT	3/4" female NPT
1855SD-90	3/4" MNPT	90° - 1/2" male flare



445



445-21



ASME MOTOR FUEL RELIEF VALVES

Sherwood relief valves for ASME motor fuel tank with 1" male pipe-a-way adaptors designed for minimum flow restrictions.

RMI Part No.	Container Connection	Relief Setting	Pipeway Adaptors	Rain Cap	Tank Type
445AM	1"	250	445-21	P206	ASME Motor Fuel
445AR	1"	312	445-21	P206	ASME Motor Fuel

SHERWOOD LIQUID LEVEL GAUGES



10A



10ARF



10B

For DOT cylinders and ASME motor fuel tanks. No. 54 drill orifice in valve limits liquid flow when no orifice is in tank.

RMI Part No.	Inlet	Dip Tube Length
12B 6.9	1/4"	5.7" for 33# cylinder
10B 12.0	1/4"	Must be cut to length
10A	1/4"	None
10ARF	1/4"	None
1931-24A	Replacement Bleeder Screw	

SHERWOOD 3866 T-CONNECTOR

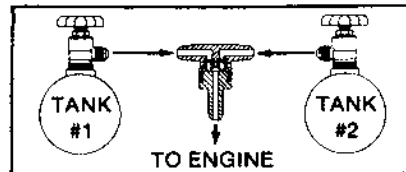

3866

Combination bulkhead fitting, two tank backcheck valves and hydrostatic relief valve for dual tank motor fuel systems. Backcheck valves provide required protection by preventing flow from one tank to other during filling operation.

RMI Part No.	2 Inlets	Outlet
3866	3/8" flare	3/8" flare
3865	1/4" Ext. Relief Valve (400 PSI)	—



3865